

DC TO AC INVERTER FOR LCD PANEL , PLIC004010080



FEATURES:

- WIDE OPERATING VOLTAGE RANGE 5.7V~14V
- LOWER HEIGHT DESIGN
- USE FOR 7"~12.1" PORTABLE DVD & CAR TV

Electrical Specifications @25°C						
ITEM	SYMBOL	MIN.	TYP.	MAX.	UNIT	REMARK
INPUT VOLTAGE	Vin	5.7	-----	14	V	
INPUT CURRENT	Iin	620	690	760	mA	Vin=5.7V
		340	380	420		Vin=10V
LAMP VOLTAGE	Vout	-----	-----	-----	Vrms	
LAMP CURRENT	Iout	4.3	4.8	5.3	mArms	LOADING=9" PANEL
LAMP FREQUENCY	F	43	48	53	KHz	LOADING=9" PANEL
OPEN LAMP VOLTAGE	Vop	1000	1300	1600	Vrms	
DIMMING VOLTAGE	Vadj	-----	-----	-----	V	
ON/OFF VOLTAGE	Von/off	0	-----	5	V	Voff=0-0.8V, Von=2.5-5V
OUTPUT POWER	P	-----	-----	-----	Watt	

DIMENSIONS [mm]

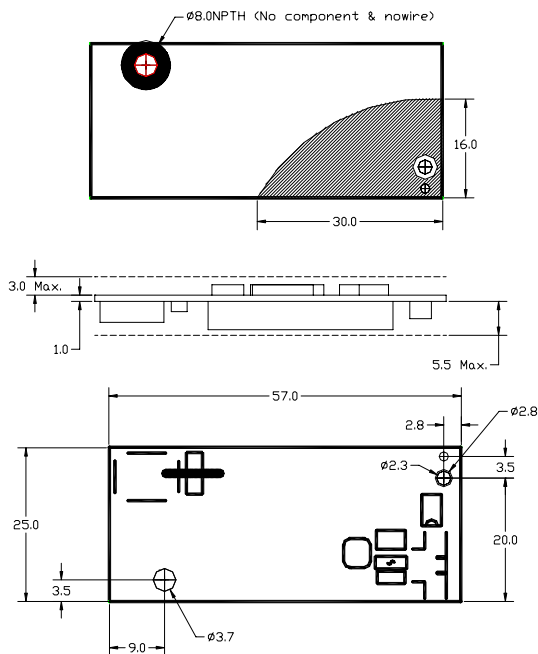

PIN ASSIGNMENT

INPUT CONNECTER J1

MOLEX (53261-0490) OR EQUIV.

PIN	SYMBOL	DESCRIPTION
1-2	GND	Ground
3	Vin	Input voltage: 5.7V-14V
4	Enable	ON: 2.5~5.0V OFF: 0~0.8V

OUTPUT CONNECTOR J2

JST (SM02B-BHSS-1-TB) OR EQUIV.

PIN	SYMBOL	DESCRIPTION
1	H.V OUTPUT	Output H.V to lamp
2	RTN	Return